



MAINTENANCE AND ATTENTION

1. This Bin is intended for household and commercial use only and should not be used for other purposes.
2. Children should not operate or play with the Bin without supervision.
3. This product is made of painted galvanized steel, use a damp cloth to clean it.
4. This product contains electronic components and is only for indoor use in dry conditions. Do not use in high temperatures (more than 45 degrees) or humid environments. This product cannot be flushed with water, but can be wiped with wet wipes to clean.
5. The lid will open slowly to indicate low battery. To ensure the bin works correctly, change the batteries as required.
6. While the bin is open, do not push down on the lid to close. It will close on its own.
7. Do not place anything on the top of the lid.

SOLUTIONS TO COMMON ERRORS

FAULT	SOLUTION
Lid not opening correctly	<ul style="list-style-type: none"> - Check that the batteries are installed correctly. - Restart the power on the bin. - Clean the sensor with a clean cloth. - Battery power may be low. If so, replace batteries.
Lid not closing properly	<ul style="list-style-type: none"> - Check whether the lid is blocked. Remove anything that may be stopping the lid from closing. - Clean the sensor with a clean cloth. - Check if the electronic components are damp. If they are, then place in a well ventilated space to dry out. Restart power when dry.
Slow lid opening	<ul style="list-style-type: none"> - Check if the batteries have been installed correctly into the bin. - Battery power may be low. If so, replace batteries.

Note: If the above solutions are not effective, please use the contact details provided on this document.

PRODUCT INTRODUCTION

The automatic opening and closing system of this product is directed by infrared sensors. When moving your hand or other objects in the direction of the sensor on the lid (around 15cm), the bin will open automatically. Once you have placed the rubbish inside, the lid will then close.



OPERATION INSTRUCTIONS

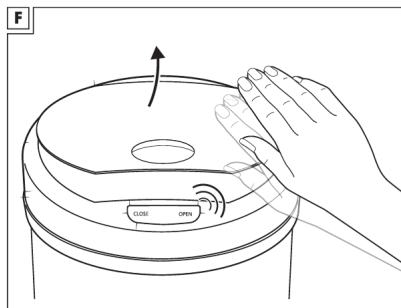
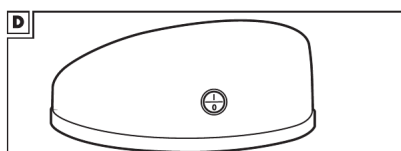
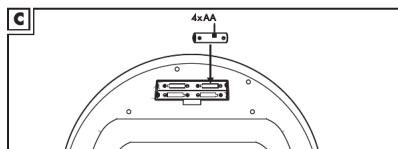
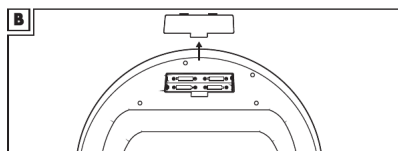
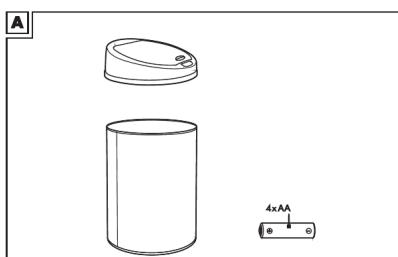

1. **STANDBY MODE:** Turn on the power switch. The product will automatically enter standby mode.
2. **AUTO MODE:** When moving your hand or other objects within 15cm (+/-5cm), the bin will open automatically. Once you have placed rubbish inside, the bin will close.
3. **MANUAL MODE:** Touch the "OPEN" switch, the lid will open. Once you have deposited rubbish inside, press the "CLOSE" button to close the lid. The product automatically enters auto mode again.
4. **MANUAL to AUTO MODE:** Using manual mode will turn off the sensor for auto mode. To reset the sensor, turn the bin off and on again at the switch.

BATTERY INSTALLATION, CARE AND DISPOSAL

1. This Bin requires 4 x AA batteries and is not compatible with any other battery size.
2. Batteries should be installed by an adult.
3. Ensure the batteries are installed correctly so the positive and negative terminals are facing the correct direction.
4. Do not mix old and new batteries or different battery types together.
Use of incorrect battery types may result in an explosion or damage to the electronics.
5. Dispose of batteries correctly.

DISTRIBUTED BY:

Visy Retail Services Pty Ltd (AU): 1300 734 714
Visy Board Limited (NZ): 0800 443 058

living-elements.com.au
living-elements.co.nz